

Legend

- Municipal Boundary
- Parcel Boundaries
- Zoning Districts**
- R-1 Single Family Residence
- R-2 Single Family Residence
- R-2A Single Family Residence
- R-2B Single Family Residence
- R-2C Single Family Residence
- R-3 General Residence
- R-4 Multiple Dwelling Residence
- R-5 Multiple Dwelling Residence
- ER-1 Estate Residential
- B-1 Neighborhood Business
- B-2 Community Business
- B-3 General Business
- B-4 Automotive Business
- BP Business Park District
- M-1 Limited Manufacturing
- OD Office District
- RR Hotel-Motel Resort & Recreational District
- STRATFORD PD
- OT Old Town District

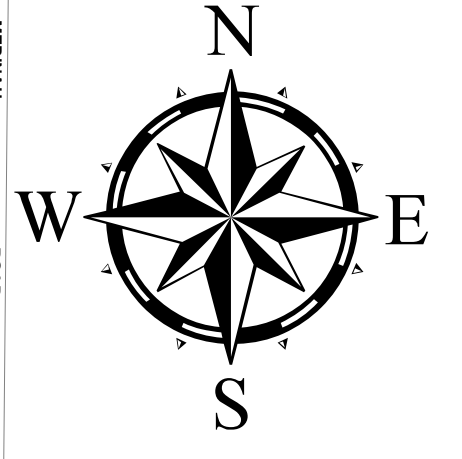
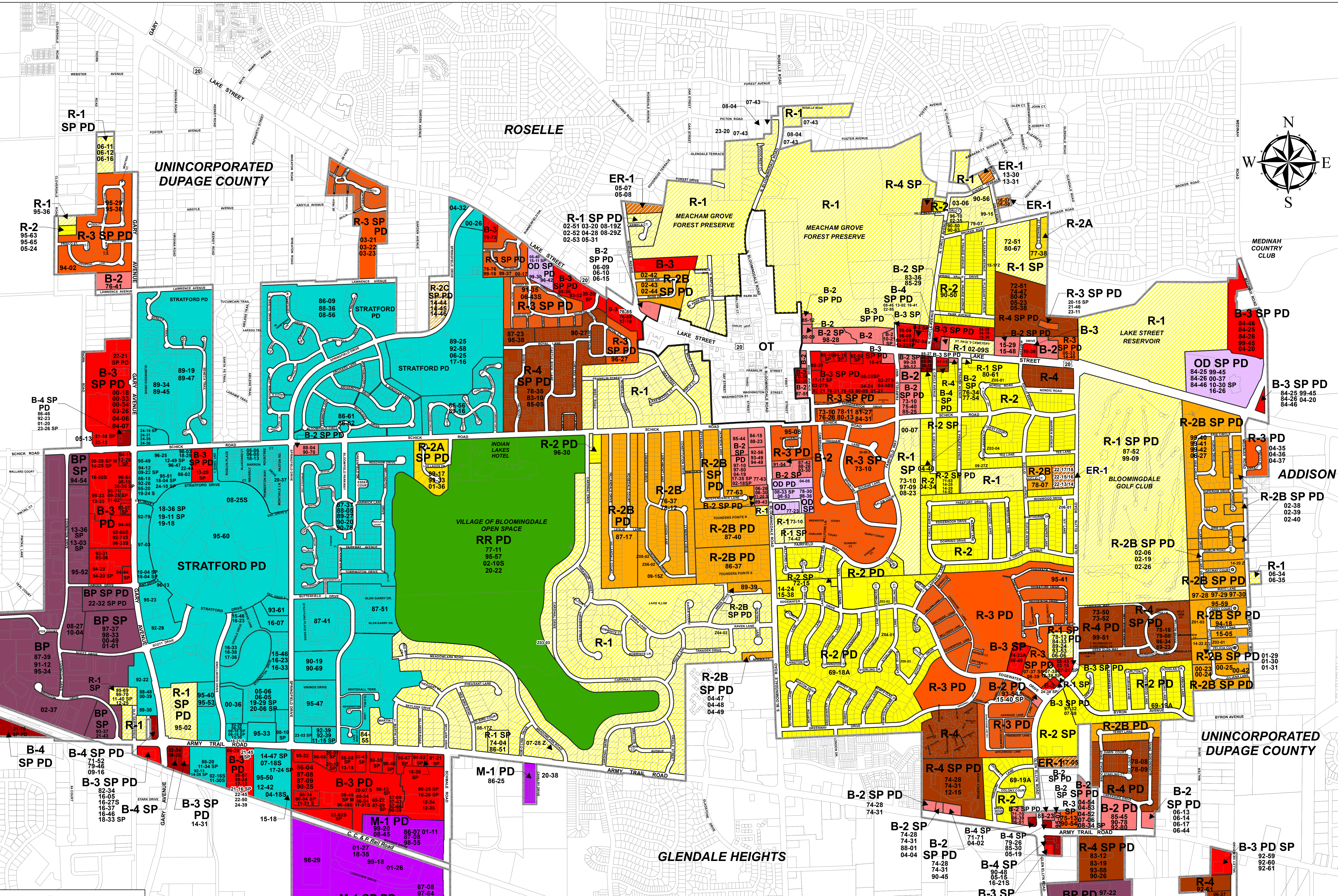

Adopted by the President and Board of Trustees
 Village of Bloomingdale, DuPage County, Illinois
 on the 24th Day of February, 2025

Paul S. Hays
 Village Clerk

[Signature]
 Village President

M - Massage Establishment
 PD - Planned Developments
 SP - Special Use
 S - Sign Ordinance
 Z - Zoning Variance Ordinance
 ZXX-XX - ZBA Approval Case Number